











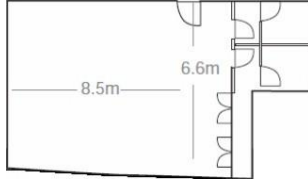

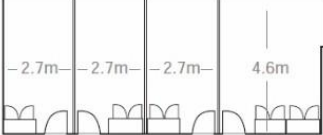

The Venue of Choice

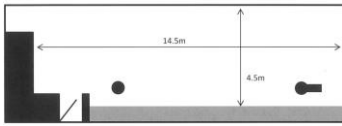
Function Room Choices...

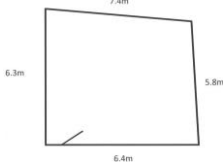
<p>Alex Parker</p>			<table border="1"> <thead> <tr> <th colspan="2">CAPACITY</th> </tr> </thead> <tbody> <tr> <td>theatre style</td> <td>40</td> </tr> <tr> <td>boardroom style</td> <td>30</td> </tr> <tr> <td>cabaret</td> <td>30</td> </tr> <tr> <td>u shape</td> <td>20</td> </tr> <tr> <td>dinner</td> <td>40</td> </tr> <tr> <td>standing reception</td> <td>50</td> </tr> <tr> <td>Room height</td> <td>2.4m</td> </tr> </tbody> </table>	CAPACITY		theatre style	40	boardroom style	30	cabaret	30	u shape	20	dinner	40	standing reception	50	Room height	2.4m		
CAPACITY																					
theatre style	40																				
boardroom style	30																				
cabaret	30																				
u shape	20																				
dinner	40																				
standing reception	50																				
Room height	2.4m																				
<p>Boardroom</p>			<table border="1"> <thead> <tr> <th colspan="2">CAPACITY</th> </tr> </thead> <tbody> <tr> <td>boardroom style</td> <td>14</td> </tr> <tr> <td>dinner</td> <td>14</td> </tr> <tr> <td>standing reception</td> <td>30</td> </tr> <tr> <td>Room height</td> <td>2.3m</td> </tr> </tbody> </table>	CAPACITY		boardroom style	14	dinner	14	standing reception	30	Room height	2.3m								
CAPACITY																					
boardroom style	14																				
dinner	14																				
standing reception	30																				
Room height	2.3m																				
<p>Brockville</p>			<table border="1"> <thead> <tr> <th colspan="2">CAPACITY</th> </tr> </thead> <tbody> <tr> <td>theatre style</td> <td>100</td> </tr> <tr> <td>boardroom style</td> <td>30</td> </tr> <tr> <td>cabaret</td> <td>50</td> </tr> <tr> <td>u shape</td> <td>30</td> </tr> <tr> <td>dinner</td> <td>90</td> </tr> <tr> <td>dinner dance</td> <td>60</td> </tr> <tr> <td>standing reception</td> <td>120</td> </tr> <tr> <td>Room height</td> <td>2.4m</td> </tr> </tbody> </table>	CAPACITY		theatre style	100	boardroom style	30	cabaret	50	u shape	30	dinner	90	dinner dance	60	standing reception	120	Room height	2.4m
CAPACITY																					
theatre style	100																				
boardroom style	30																				
cabaret	50																				
u shape	30																				
dinner	90																				
dinner dance	60																				
standing reception	120																				
Room height	2.4m																				
<p>Boxes</p>			<table border="1"> <thead> <tr> <th colspan="2">CAPACITY</th> </tr> </thead> <tbody> <tr> <td>boardroom style</td> <td>10</td> </tr> <tr> <td>dinner</td> <td>10</td> </tr> <tr> <td>standing reception</td> <td>12</td> </tr> <tr> <td>Room height</td> <td>2.4m</td> </tr> </tbody> </table>	CAPACITY		boardroom style	10	dinner	10	standing reception	12	Room height	2.4m								
CAPACITY																					
boardroom style	10																				
dinner	10																				
standing reception	12																				
Room height	2.4m																				
<p>Eleven Lounge</p>			<table border="1"> <thead> <tr> <th colspan="2">CAPACITY</th> </tr> </thead> <tbody> <tr> <td>theatre style</td> <td>70</td> </tr> <tr> <td>boardroom style</td> <td>30</td> </tr> <tr> <td>cabaret</td> <td>30</td> </tr> <tr> <td>u shape</td> <td>20</td> </tr> <tr> <td>dinner</td> <td>60</td> </tr> <tr> <td>standing reception</td> <td>70</td> </tr> </tbody> </table>	CAPACITY		theatre style	70	boardroom style	30	cabaret	30	u shape	20	dinner	60	standing reception	70				
CAPACITY																					
theatre style	70																				
boardroom style	30																				
cabaret	30																				
u shape	20																				
dinner	60																				
standing reception	70																				
<p>My Future's In Falkirk</p>			<table border="1"> <thead> <tr> <th colspan="2">CAPACITY</th> </tr> </thead> <tbody> <tr> <td>theatre style</td> <td>30</td> </tr> <tr> <td>boardroom style</td> <td>20</td> </tr> <tr> <td>cabaret</td> <td>20</td> </tr> <tr> <td>u shape</td> <td>15</td> </tr> <tr> <td>dinner</td> <td>30</td> </tr> <tr> <td>standing reception</td> <td>40</td> </tr> <tr> <td>Room height</td> <td>2.4m</td> </tr> </tbody> </table>	CAPACITY		theatre style	30	boardroom style	20	cabaret	20	u shape	15	dinner	30	standing reception	40	Room height	2.4m		
CAPACITY																					
theatre style	30																				
boardroom style	20																				
cabaret	20																				
u shape	15																				
dinner	30																				
standing reception	40																				
Room height	2.4m																				
<p>Westfield Lounge</p>			<table border="1"> <thead> <tr> <th colspan="2">CAPACITY</th> </tr> </thead> <tbody> <tr> <td>Dinner</td> <td>120</td> </tr> <tr> <td>Dinner Dance</td> <td>120</td> </tr> </tbody> </table>	CAPACITY		Dinner	120	Dinner Dance	120												
CAPACITY																					
Dinner	120																				
Dinner Dance	120																				

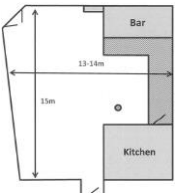
Alex Parker Lounge

Room Specifics...

Perfect for small to medium sized business meetings and functions.

- *Modern, fresh décor.*
- *Single aspect windows running along one wall overlooking FFC Pitch.*
- *Full or ½ day hire for business use.*
- *Flat Screen TV for presentations.*
- **FREE WIFI.**
- *Lift and Stair Access.*
- *Scan this QR Code for a Video Tour...*



Adobe Flash Required or visit www.360pix.co.uk/tours/falkirkfc/

CAPACITY	
theatre style	40
boardroom style	30
cabaret	30
u shape	20
dinner	40
standing reception	50
Room height	2.4m



Alex Parker Lounge Set up for a Business Presentation

The Boardroom

Room Specifics...

Perfect for business meetings.

- *Traditional, impressive décor.*
- *Single aspect windows running along one with views towards Falkirk town.*
- *Full or ½ day hire for business use.*
- *Flat Screen TV for presentations.*
- **FREE WIFI**
- *Lift and Stair Access*
- *Scan this QR Code for a Video Tour...*



Adobe Flash Required or visit www.360pix.co.uk/tours/falkirkfc/

CAPACITY	
boardroom style	14
dinner	14
standing reception	30
Room height	2.3m

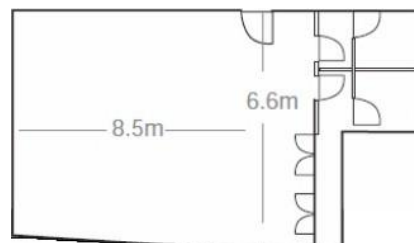

The Boardroom

Brockville Lounge

Room Specifics...

Perfect for medium to larger sized business meetings and functions.

- *Modern, fresh décor.*
- *Single aspect windows running along one wall overlooking FFC Pitch.*
- *Full or ½ day hire for business use.*
- *Flat Screen TV for presentations.*
- **FREE WIFI**
- *Lift and Stair Access*
- *Scan this QR code for a Video Tour...*



Adobe Flash Required or visit www.360pix.co.uk/tours/falkirkfc/

CAPACITY	
theatre style	100
boardroom style	30
cabaret	50
u shape	30
dinner	90
dinner dance	60
standing reception	120
Room height	2.4m



Brockville Lounge Set up for a Boardroom Style Meeting

Corporate Boxes

Room Specifics...

Perfect for small and intimate business meetings and functions.

- *Modern, fresh décor.*
- *4 Boxes to choose from...International, Captains, 1957 and Managers.*
- *Single aspect windows running along one wall overlooking FFC Pitch.*
- *Full or ½ day hire for business use.*
- *Flat Screen TV for presentations.*
- **FREE WIFI**
- *Lift and Stair Access*
- *Scan the QR Code for a Video Tour...*

CAPACITY	
boardroom style	10
dinner	10
standing reception	12
Room height	2.4m

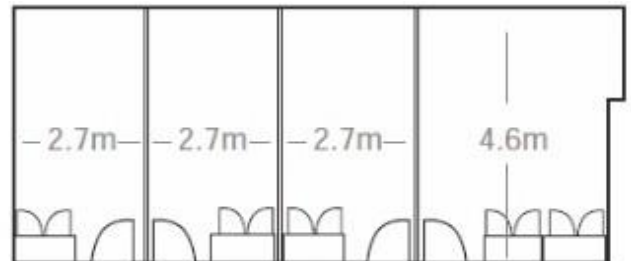

Corporate Box

Adobe Flash Required or visit
www.360pix.co.uk/tours/falkirkfc/

Eleven Lounge

Room Specifics...

Perfect for medium to larger sized business meetings and functions.

- *Modern, fresh décor.*
- *Single aspect windows running along one wall overlooking FFC Pitch.*
- *Full or ½ day hire for business use.*
- *Flat Screen TV for presentations.*
- *FREE WIFI*
- *Lift and Stair Access*

CAPACITY	
theatre style	70
boardroom style	30
cabaret	30
u shape	20
dinner	60
standing reception	70

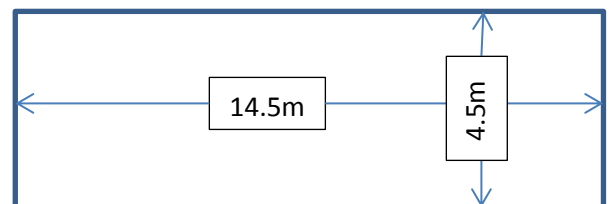

Eleven Lounge Set up for a Wedding Reception

My Future's in Falkirk Suite

Room Specifics...

Perfect for informal meetings, workshops and training courses.

- *Modern, fresh décor.*
- *Single aspect windows running along one wall with views over Falkirk town.*
- *Full or ½ day hire for business use.*
- *Flat Screen TV for presentations.*
- **FREE WIFI**
- *Lift and Stair Access*
- *Scan this QR Code for a Video Tour...*



Adobe Flash Required or visit www.360pix.co.uk/tours/falkirkfc/

CAPACITY	
theatre style	30
boardroom style	20
cabaret	20
u shape	15
dinner	30
standing reception	40
Room height	2.4m

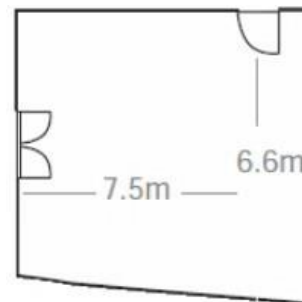

The Westfield Lounge

Room Specifics...

Perfect for larger functions, parties, shows, AGM's and wedding receptions.

- *Modern, quality furniture and fittings.*
- *Double aspect room with views over the FFC pitch and towards Falkirk town.*
- *Fully fitted bar.*
- *Large Projector Screen.*
- *FREE WIFI*
- *Lift and Stair Access*
- *Day Hire available at weekends only.*

CAPACITY

Dinner 120

Dinner Dance 120

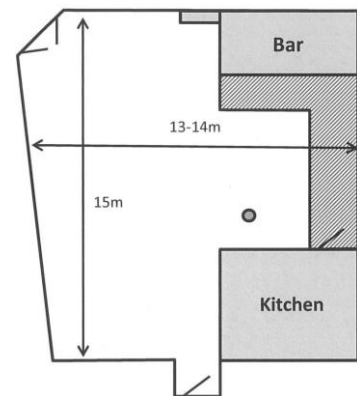

Christmas Party Night